

THIS DRAWING IS COPYRIGHT. IS ALL DIMENSIONS TO BE CHECKED ON SITE PRIOR TO COMMENCEMENT OF WORK. ROCK TOWNSEND LTD TO BE NOTIFIED OF ANY DIMENSIONS OR ERRORS. THIS DRAWING IS NOT TO BE SCALED.

SETTING OUT - NOTE FOR CONTRACTOR

IT IS THE RESPONSIBILITY OF THE CONTRACTOR TO CHECK ALL SETTING OUT INFORMATION (LEVEL, DIMENSIONS, COORDINATE, ETC) INDICATED ON THIS DRAWING FOR THE WHOLE OF THE WORKS PRIOR TO COMMENCEMENT OF THE WORKS AND RECORD THE RESULTS ON A COPY OF THIS DRAWING. ROCK TOWNSEND SHALL BE NOTIFIED OF ANY DISCREPANCIES AND NO WORK SHALL BE COMMENCED UNTIL FURTHER INSTRUCTIONS ARE RECEIVED IN WRITING.

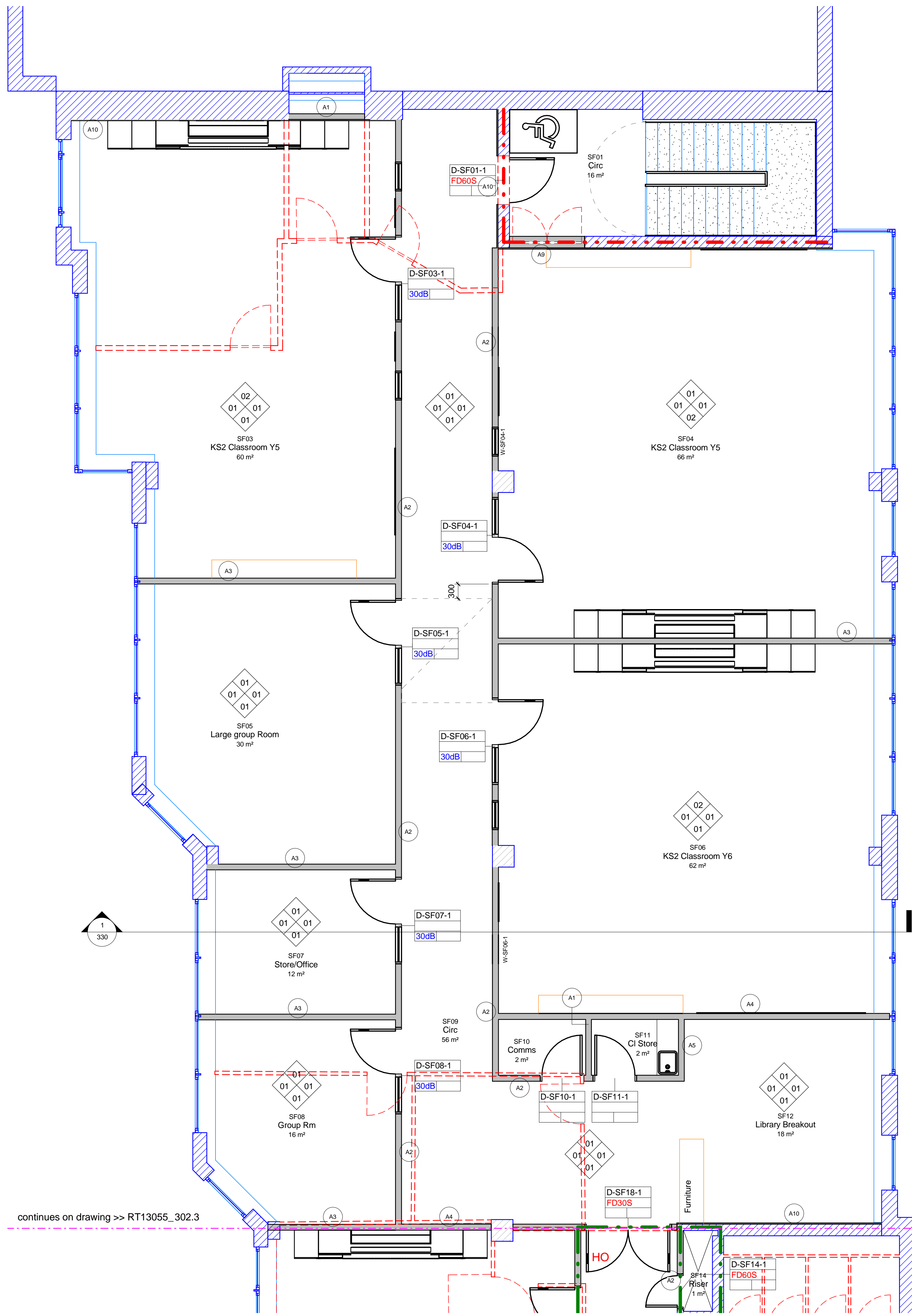

continues on drawing >> RT13055_302.3

- Key:**
- Existing
 - Demolition
 - New Construction
 - Client Supply

- FINISHES KEY:**
- 01. Emulsion paint. Specification Reference M60/110 or M60/150 eggshell finish to corridors, stairs and main hall. Colour : Off White. Dulux 10BB 83/006
 - 02. Emulsion paint. Specification Reference M60/110. Colour : Grey.

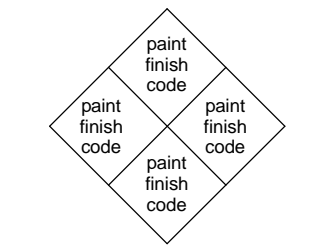

- FIRE RATING KEY :**
- FD30
 - FD60

 Casework removed - Floor made good

NOTES:
Please refer to DWG 453 - Partition Types for wall types

P8	GAs amended in line with Exova report 020915	07/09/15	RS
P7	GAs changed to 1:50 to add fire ratings, acoustic ratings, wall types	26/08/15	PB
P6	SF25 location updated & SF38 W/C added	29/07/15	PB
P5	Classroom Layout & Room No. updated	23/07/15	PB
P4	General Update	13/07/15	PB
P3	General Update	01/06/15	CH
P2	General Update	30/06/15	CH
P1	Initial Issue	28/06/15	CH

REVISIONS	DATE/DRAWN
-----------	------------

KEYPLAN	
PROJECT	St Jerome School
	Station Road, Harrow
DRAWING TITLE	GA Plan
	Level 2 West
DATE	17/08/15
DRAWN	PB
SCALE	As indicated @ A1
CHECK	
STATUS	Proposed
JOB NO.	15028
DRAWING NO.	302.1
REVISION	P8

www.rocktownsend.co.uk

Rock Townsend